

VER	DESCRIPTION OF REVISIONS	DATE
A-0		2022/11/03

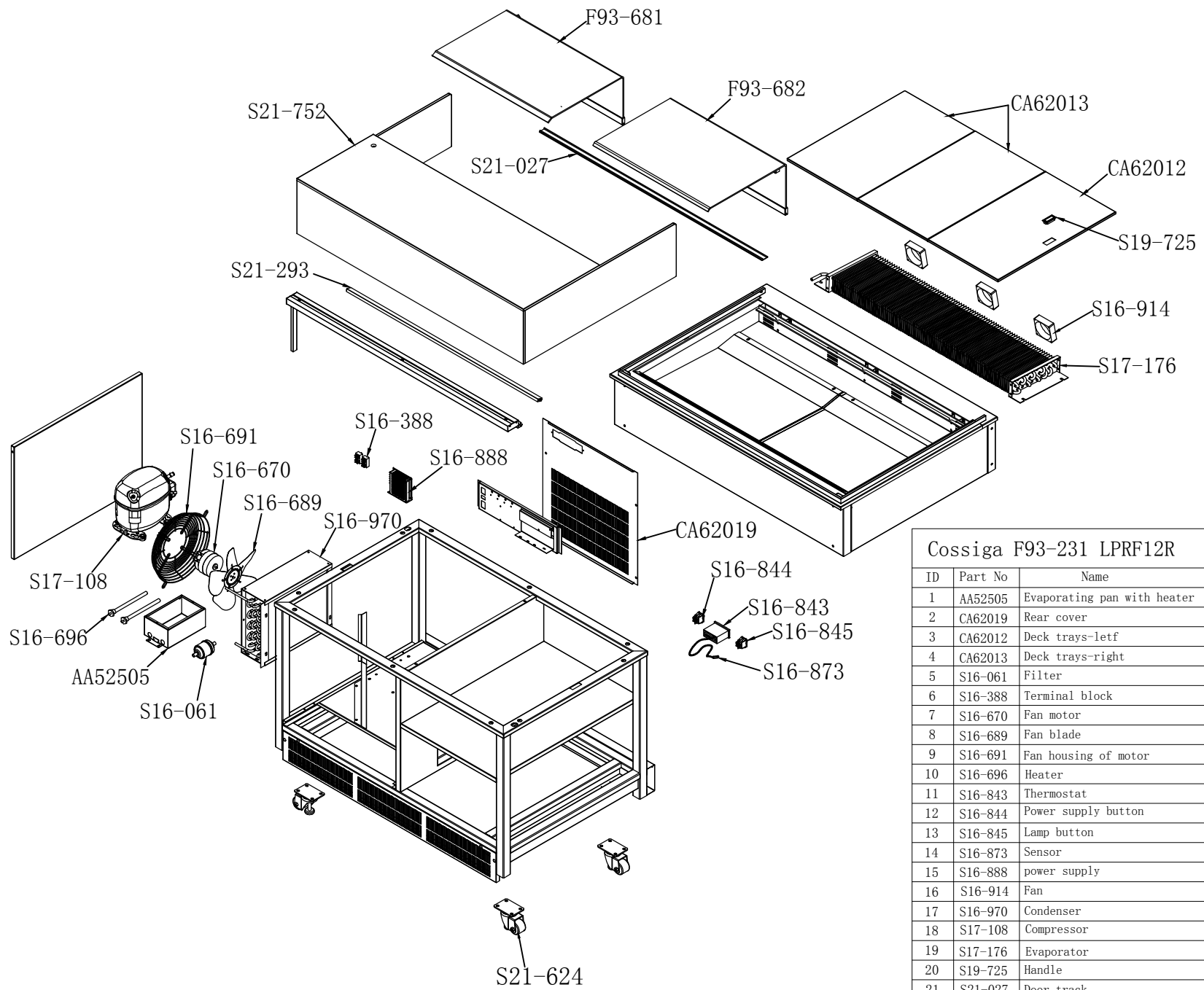

Cossiga F93-231 LPRF12R						
ID	Part No	Name	Spec	Unit	QTY	Note
1	AA52505	Evaporating pan with heater		PCS	1	
2	CA62019	Rear cover		PCS	1	
3	CA62012	Deck trays-left		PCS	1	
4	CA62013	Deck trays-right		PCS	2	
5	S16-061	Filter	DML-053S-3/8"	PCS	1	
6	S16-388	Terminal block	250VAC, 2.5MM2	PCS	3	
7	S16-670	Fan motor	SP-B16HUEM2 (16W)	PCS	1	
8	S16-689	Fan blade	FV100CW30S50	PCS	1	
9	S16-691	Fan housing of motor	Φ280-80	PCS	1	
10	S16-696	Heater	190W	PCS	2	
11	S16-843	Thermostat	Dixell XR06CX-5NOC1 240V/50HZ	PCS	1	
12	S16-844	Power supply button	22A 125/250VAC, Green	PCS	1	
13	S16-845	Lamp button	22A 125/250VAC, Yellow	PCS	1	
14	S16-873	Sensor	Dixell NG6 3M	PCS	1	
15	S16-888	power supply	LRS-75-12, 12V/6A	PCS	1	
16	S16-914	Fan	SUNON, 220-240V~50/60Hz	PCS	3	
17	S16-970	Condenser	350x288x122, Φ7	PCS	1	
18	S17-108	Compressor	SECOP, SC15MNX/R290	PCS	1	
19	S17-176	Evaporator	935x250x70, Φ9.52	PCS	1	
20	S19-725	Handle		PCS	1	
21	S21-027	Door track		M	1.2	
22	S21-293	LED light	L=700	PCS	2	
23	S21-624	Adjustable Castor	2"	PCS	4	
24	S21-752	glass cover(outer)		PCS	1	
25	F93-681	Rear PC Door Assy - Left		PCS	1	
26	F93-682	Rear PC Door Assy - Right		PCS	1	